

Hamilton Transit
BUS MAINTENANCE & STORAGE FACILITY

Appendix B

Natural Heritage

January 3, 2020

Prepared for



Prepared by



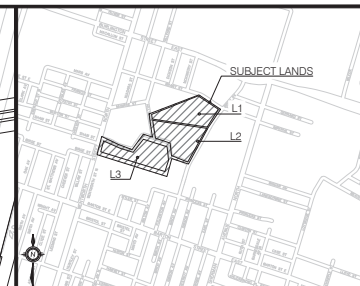
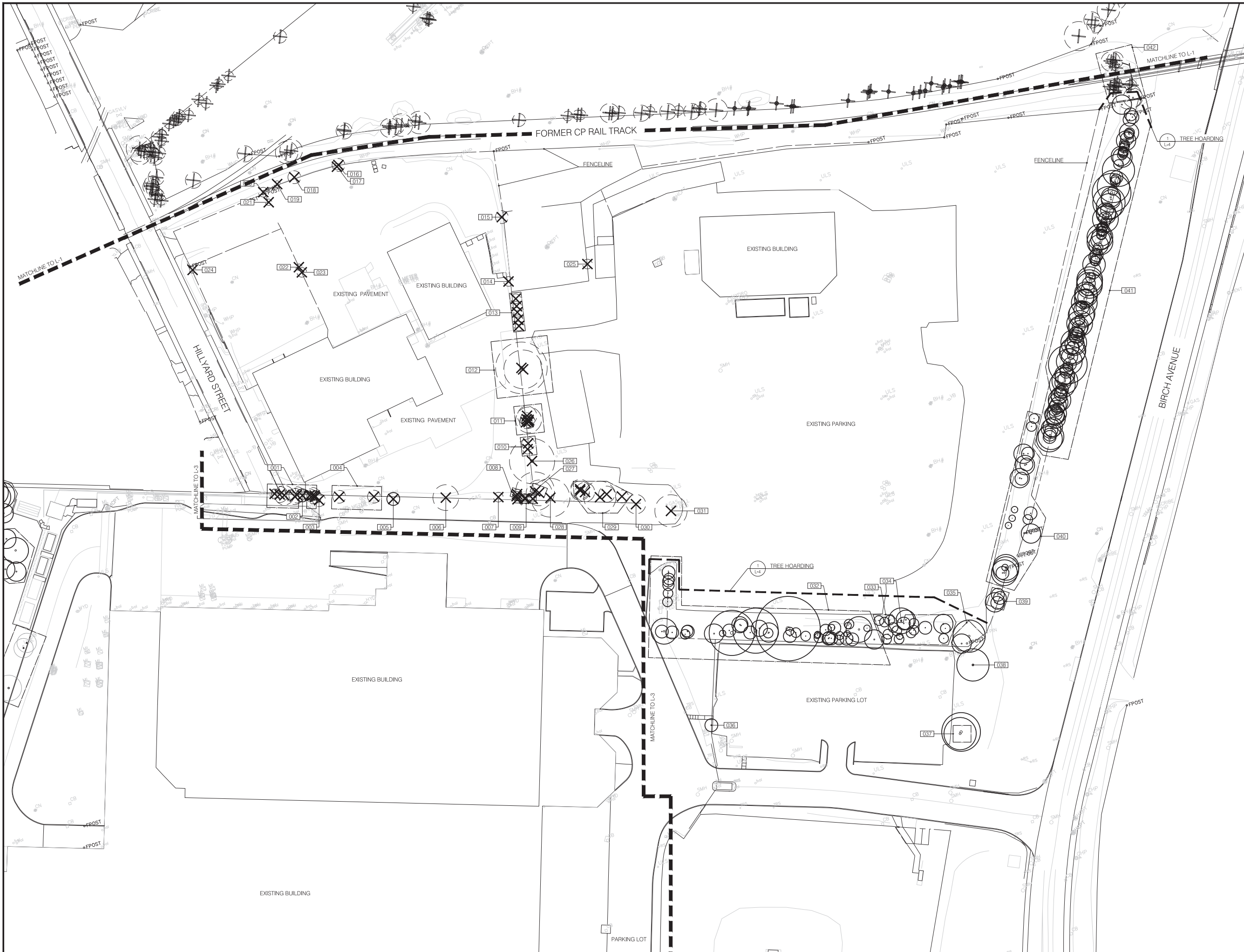

KEY MAP - N.T.S.

- LEGEND**
- EX. DECIDUOUS TREE TO REMAIN
 - EX. CONIFEROUS TREE TO REMAIN
 - EX. DECIDUOUS TREE TO BE REMOVED
 - STUMP TO BE REMOVED
 - TREE SHOWN ON SURVEY BUT NOT OBSERVED IN THE FIELD
 - TEMPORARY TREE HOARDING ON L-4
 - TREE GROUP
 - DETAIL NUMBER SHEET NUMBER
 - TREE TAG / IDENTIFICATION

NOT FOR CONSTRUCTION

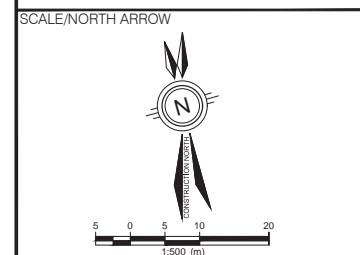

DESIGNED BY:	Z.B.	CHECKED BY:	J.M.
DRAWN BY:	Z.B.	DATE:	03/2018

#	DATE	BY	DESCRIPTION
2	2018-05-08	ZB	RE-SUBMITTED FOR CITY OF HAMILTON REVIEW
1	2018-03-23	ZB	SUBMITTED FOR CITY OF HAMILTON REVIEW

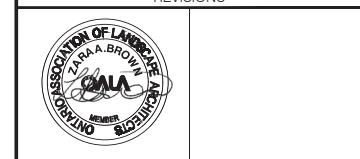

APPROVALS

IBI GROUP
 200 East Wing-360 James Street North
 Hamilton ON L8L 1H5 Canada
 tel 905 546 1010 fax 905 546 1011
 ibigroup.com

CITY OF HAMILTON
 ONTARIO, CANADA

HAMILTON TRANSIT FACILITY
 2 HILLYARD ST & 330 WENTWORTH ST N
 HAMILTON, ONTARIO

TREE PROTECTION PLAN

FILE NUMBER:	115096_TPP	SHEET NUMBER:	L-2
--------------	------------	---------------	-----

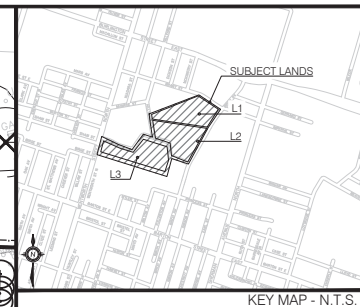
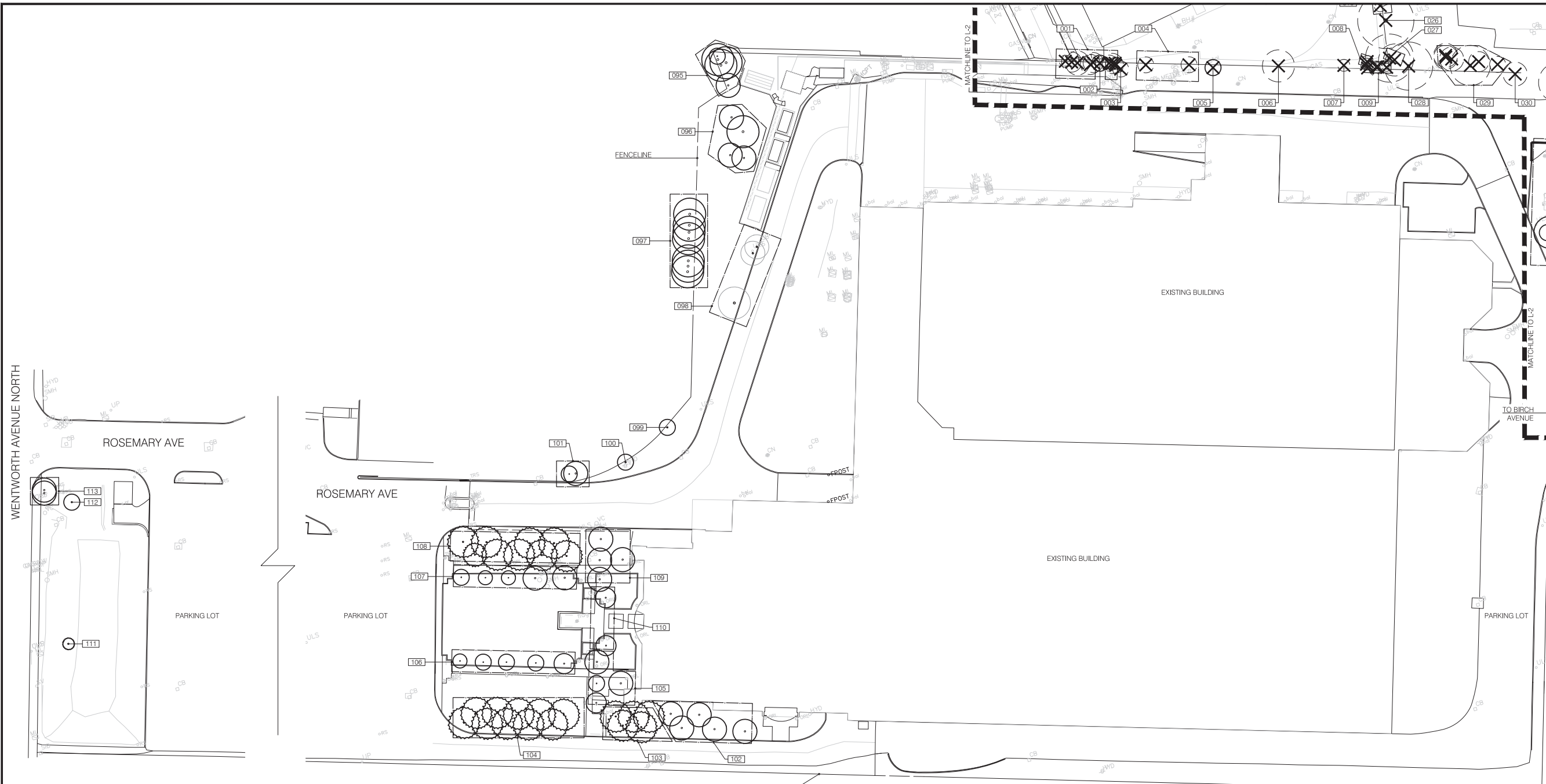

- LEGEND**
- EX. DECIDUOUS TREE TO REMAIN
 - EX. CONIFEROUS TREE TO REMAIN
 - EX. DECIDUOUS TREE TO BE REMOVED
 - STUMP TO BE REMOVED
 - TREE SHOWN ON SURVEY BUT NOT OBSERVED IN THE FIELD
 - TEMPORARY TREE HOARDING ON L-4
 - TREE GROUP
 - DETAIL NUMBER SHEET NUMBER
 - TREE TAG / IDENTIFICATION

NOT FOR CONSTRUCTION

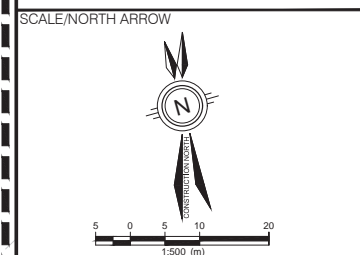

DESIGNED BY: Z.B. CHECKED BY: J.M.
 DRAWN BY: Z.B. DATE: 03/2018

#	DATE	BY	DESCRIPTION
2	2018-05-08	ZB	RE-SUBMITTED FOR CITY OF HAMILTON REVIEW
1	2018-03-23	ZB	SUBMITTED FOR CITY OF HAMILTON REVIEW

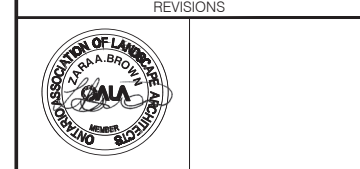

IBI GROUP
 200 East Wing-360 James Street North
 Hamilton ON L8L 1H5 Canada
 tel 905 546 1010 fax 905 546 1011
 ibigroup.com

CITY OF HAMILTON
 ONTARIO, CANADA

HAMILTON TRANSIT FACILITY
 330 WENTWORTH ST N
 HAMILTON, ONTARIO

TREE PROTECTION PLAN

FILE NUMBER: 115096_TPP SHEET NUMBER: L-3

EXISTING TREE IDENTIFICATION TABLE

ID	BOTANICAL NAME	COMMON NAME	DBH (RANGE)	# OF UNITS	CONDITION(1)	COMMENTS(2)	IMPACTS OF DEVELOPMENT (3)	OWNERSHIP(4)	RECOMMENDATION (5)
1	ALANTHUS ALTISSIMA	TREE OF HEAVEN	12-25	8	F	INVASIVE; ADJACENT PROPERTY	IMPACTED; SITE REMEDIATION	M	REMOVE
2	RHUS TYPHINA	STAGHORN SUMAC	15	1	F	ADJACENT PROPERTY	IMPACTED; SITE REMEDIATION	M	REMOVE
3	ALANTHUS ALTISSIMA	TREE OF HEAVEN	18	1	P	INVASIVE; ADJACENT PROPERTY; EMBEDDED IN FENCE	IMPACTED; SITE REMEDIATION	M	REMOVE
4	ALANTHUS ALTISSIMA	TREE OF HEAVEN	13	2	F	INVASIVE; ADJACENT PROPERTY; LEANING ON FENCE	IMPACTED; SITE REMEDIATION	M	REMOVE
5	ULMUS PUMILA	SIBERIAN ELM	12	1	F	ADJACENT PROPERTY	IMPACTED; SITE REMEDIATION	M	REMOVE
6	ALANTHUS ALTISSIMA	TREE OF HEAVEN	40	1	P	INVASIVE; ADJACENT PROPERTY; LEANING ON FENCE	IMPACTED; SITE REMEDIATION	M	REMOVE
7	ALANTHUS ALTISSIMA	TREE OF HEAVEN	10	1	P	INVASIVE; SEVERE TRUNK DAMAGE; LEANING	IMPACTED; SITE REMEDIATION	M	REMOVE
8	ALANTHUS ALTISSIMA	TREE OF HEAVEN	10-15	2	F	INVASIVE; ADJACENT PROPERTY; ROOTS EMBEDDED IN FENCE	IMPACTED; SITE REMEDIATION	M	REMOVE
9	ALANTHUS ALTISSIMA	TREE OF HEAVEN	10-15	4	F	INVASIVE; EXPOSED ROOTS; LEANING	IMPACTED; SITE REMEDIATION	M	REMOVE
10	ALANTHUS ALTISSIMA	TREE OF HEAVEN	10-25	2	P/D	INVASIVE; LARGER TREE EMBEDDED IN FENCE; SMALLER TREE DEAD	IMPACTED; SITE REMEDIATION	M	REMOVE
11	ULMUS PUMILA	SIBERIAN ELM	18-36	6	F	DAMAGED LEADERS	IMPACTED; SITE REMEDIATION	M	REMOVE
12	ULMUS PUMILA	SIBERIAN ELM	55-80	2	F		IMPACTED; SITE REMEDIATION	M	REMOVE
13	ALANTHUS ALTISSIMA	TREE OF HEAVEN	15-30	5	P	INVASIVE	IMPACTED; SITE REMEDIATION	M	REMOVE
14	ALANTHUS ALTISSIMA	TREE OF HEAVEN	12	1	P	INVASIVE; ROOTS EMBEDDED IN FENCE; POOR STRUCTURE	IMPACTED; SITE REMEDIATION	M	REMOVE
15	ALANTHUS ALTISSIMA	TREE OF HEAVEN	25	1	P	INVASIVE; ROOTS EMBEDDED IN FENCE; POOR STRUCTURE	IMPACTED; SITE REMEDIATION	M	REMOVE
16	ALANTHUS ALTISSIMA	TREE OF HEAVEN	20	1	P	INVASIVE; POOR STRUCTURE	IMPACTED; SITE REMEDIATION	M	REMOVE
17	ALANTHUS ALTISSIMA	TREE OF HEAVEN	10	1	F	INVASIVE; CODOMINANT STEMS (3)	IMPACTED; SITE REMEDIATION	M	REMOVE
18	ACER NEGUNDO	MANITоба MAPLE	25	1	P	EMBEDDED IN FENCE; POOR STRUCTURE	IMPACTED; SITE REMEDIATION	M	REMOVE
19	ALANTHUS ALTISSIMA	TREE OF HEAVEN	10	1	P	INVASIVE; EMBEDDED IN FENCE; POOR STRUCTURE	IMPACTED; SITE REMEDIATION	M	REMOVE
20	ULMUS PUMILA	SIBERIAN ELM	30	1	P	BROKEN CENTRAL LEADER	IMPACTED; SITE REMEDIATION	M	REMOVE
21	ALANTHUS ALTISSIMA	TREE OF HEAVEN	12	1	F	INVASIVE; EMBEDDED IN FENCE; POOR STRUCTURE	IMPACTED; SITE REMEDIATION	M	REMOVE
22	ALANTHUS ALTISSIMA	TREE OF HEAVEN	16	1	P	INVASIVE; EMBEDDED IN FENCE	IMPACTED; SITE REMEDIATION	M	REMOVE
23	ACER NEGUNDO	MANITоба MAPLE	15	1	P	EMBEDDED IN FENCE	IMPACTED; SITE REMEDIATION	M	REMOVE
24	ULMUS PUMILA	SIBERIAN ELM	10	1	P	EMBEDDED IN FENCE	IMPACTED; SITE REMEDIATION	M	REMOVE
25	ALANTHUS ALTISSIMA	TREE OF HEAVEN	30	1	P	INVASIVE; SEVERE BRANCH DAMAGE; POOR STRUCTURE	IMPACTED; SITE REMEDIATION	M	REMOVE
26	ALANTHUS ALTISSIMA	TREE OF HEAVEN	70	4	P	INVASIVE; MODERATE BRANCH DAMAGE; POOR STRUCTURE	IMPACTED; SITE REMEDIATION	M	REMOVE
27	ALANTHUS ALTISSIMA	TREE OF HEAVEN	35-50	2	P	INVASIVE; MODERATE BRANCH DAMAGE; POOR STRUCTURE	IMPACTED; SITE REMEDIATION	M	REMOVE
28	(DEAD)		55	1	D		IMPACTED; SITE REMEDIATION	M	REMOVE
29	ULMUS PUMILA	SIBERIAN ELM	20-50	6	F	MODERATE BRANCH DAMAGE	IMPACTED; SITE REMEDIATION	M	REMOVE
30	ACER NEGUNDO	MANITоба MAPLE	20	1	P	POOR STRUCTURE	IMPACTED; SITE REMEDIATION	M	REMOVE
31	ULMUS PUMILA	SIBERIAN ELM	43	1	F		IMPACTED; SITE REMEDIATION	M	REMOVE
32	ULMUS PUMILA	SIBERIAN ELM	10-110	42	F		NONE	M	PRESERVE
33	ACER PLATANOIDES	NORWAY MAPLE	18-32	5	F	SOME TREES LEANING; ADJACENT TO FENCE; FAIR STRUCTURE	NONE	M	PRESERVE
34	CRATAEGUS SPP	HAWTHORN TREE	16	1	F		NONE	M	PRESERVE
35	ACER PLATANOIDES	NORWAY MAPLE	10-24	18	F	FAIR STRUCTURE	NONE	M	PRESERVE
36	POPULUS DELTOIDES	COTTONWOOD TREE	32	1	F	TRUNK DAMAGE	NONE	M	PRESERVE
37	ACER PLATANOIDES	NORWAY MAPLE	30-50	2	P	TRUNK DAMAGE	NONE	M	PRESERVE
38	ULMUS PUMILA	SIBERIAN ELM	16	1	F	EMBEDDED IN FENCE; CODOMINANT LEADERS (2)	NONE	M	PRESERVE
39	ULMUS PUMILA	SIBERIAN ELM	40-55	2	F		NONE	M	PRESERVE
40	ULMUS PUMILA	SIBERIAN ELM	50	1	P	LOWER BRANCH DAMAGE; LEANING	NONE	M	PRESERVE
41	ULMUS PUMILA	SIBERIAN ELM	20-35	4	F	ADJACENT TO GABION EMBANKMENT; FUSING OF LEADERS	NONE	M	PRESERVE
42	ULMUS PUMILA	SIBERIAN ELM	10-30	19	F	MODERATE BRANCH DAMAGE; SLIGHT LEAN	NONE	M	PRESERVE
43	ULMUS PUMILA	SIBERIAN ELM	10-70	141	P	15% LEADER DEATH; TOP OF SOME LEADERS BENDING; EMBEDDED IN PAIGE WIRE FENCE; MODERATE TO SEVERE BRANCH DAMAGE	NONE	M	PRESERVE
44	ULMUS PUMILA	SIBERIAN ELM	10-55	16	P	MODERATE TO SEVERE BRANCH LEADER DAMAGE	IMPACTED; SITE REMEDIATION	M	REMOVE
45	ACER NEGUNDO	MANITоба MAPLE	50	1	P	EMBEDDED IN FENCE; INTERFERING WITH UTILITY LINES	IMPACTED; SITE REMEDIATION	M	REMOVE
46	ULMUS PUMILA	SIBERIAN ELM	12	1	P	EMBEDDED IN FENCE; POOR STRUCTURE	IMPACTED; SITE REMEDIATION	M	REMOVE
47	ALANTHUS ALTISSIMA	TREE OF HEAVEN	10	1	F	INVASIVE; SPROUTING	IMPACTED; SITE REMEDIATION	M	REMOVE
48	ULMUS PUMILA	SIBERIAN ELM	15	1	P	SLIGHT NED IN CENTRAL LEADER; POOR STRUCTURE	IMPACTED; SITE REMEDIATION	M	REMOVE
49	ACER NEGUNDO	MANITоба MAPLE	35	1	P	POOR STRUCTURE; INTERFERING WITH UTILITY LINES	IMPACTED; SITE REMEDIATION	M	REMOVE
50	ALANTHUS ALTISSIMA	TREE OF HEAVEN	30	1	P	INVASIVE; POOR STRUCTURE	IMPACTED; SITE REMEDIATION	M	REMOVE
51	ALANTHUS ALTISSIMA	TREE OF HEAVEN	35-65	2	P	INVASIVE; EMBEDDED IN FENCE; CODOMINANT LEADERS (6); MODERATE LEADER DAMAGE	IMPACTED; SITE REMEDIATION	M	REMOVE
52	ALANTHUS ALTISSIMA	TREE OF HEAVEN	40	1	P	INVASIVE; CODOMINANT LEADERS (3) WITH INCLUDED BARK; WRAPPED IN BARBED WIRE	IMPACTED; SITE REMEDIATION	M	REMOVE
53	ACER NEGUNDO	MANITоба MAPLE	10	2	P	CODOMINANT LEADERS (5)	IMPACTED; SITE REMEDIATION	M	REMOVE
54	ALANTHUS ALTISSIMA	TREE OF HEAVEN	15	1	F	INVASIVE; EMBEDDED IN BARBED WIRE	IMPACTED; SITE REMEDIATION	M	REMOVE
55	ALANTHUS ALTISSIMA	TREE OF HEAVEN	10	1	P	INVASIVE; POOR STRUCTURE; INTERFERING WITH UTILITY LINES	IMPACTED; SITE REMEDIATION	M	REMOVE
56	ALANTHUS ALTISSIMA	TREE OF HEAVEN	10	1	P	INVASIVE; SEVERE BRANCH DAMAGE; EMBEDDED IN BARBED WIRE	IMPACTED; SITE REMEDIATION	M	REMOVE
57	ALANTHUS ALTISSIMA	TREE OF HEAVEN	14	1	P	INVASIVE; POOR STRUCTURE; BLACK GROWTH ON LEADER AND BRANCHES	IMPACTED; SITE REMEDIATION	M	REMOVE
58	ALANTHUS ALTISSIMA	TREE OF HEAVEN	12	1	D	INVASIVE;	IMPACTED; SITE REMEDIATION	M	REMOVE
59	ALANTHUS ALTISSIMA	TREE OF HEAVEN	14	1	D	INVASIVE;	IMPACTED; SITE REMEDIATION	M	REMOVE
60	ALANTHUS ALTISSIMA	TREE OF HEAVEN	30	1	D	INVASIVE;	IMPACTED; SITE REMEDIATION	M	REMOVE
61	ALANTHUS ALTISSIMA	TREE OF HEAVEN	18-25	2	P	INVASIVE;	IMPACTED; SITE REMEDIATION	M	REMOVE
62	ALANTHUS ALTISSIMA	TREE OF HEAVEN	12-20	2	F	INVASIVE;	IMPACTED; SITE REMEDIATION	M	REMOVE
63	ALANTHUS ALTISSIMA	TREE OF HEAVEN	20	1	F	INVASIVE;	IMPACTED; SITE REMEDIATION	M	REMOVE
64	ULMUS PUMILA	SIBERIAN ELM	12	1	F	MINOR TRUNK DAMAGE; POOR LOWER BRANCHING	IMPACTED; SITE REMEDIATION	M	REMOVE
65	ALANTHUS ALTISSIMA	TREE OF HEAVEN	12-45	2	F	INVASIVE; MINOR TRUNK DAMAGE; CONCRETE AT TRUNK BASE	IMPACTED; SITE REMEDIATION	M	REMOVE
66	ALANTHUS ALTISSIMA	TREE OF HEAVEN	10-40	25	P	INVASIVE;	IMPACTED; SITE REMEDIATION	M	REMOVE
67	ALANTHUS ALTISSIMA	TREE OF HEAVEN	10-20	12	F	INVASIVE;	IMPACTED; SITE REMEDIATION	M	REMOVE
68	ALANTHUS ALTISSIMA	TREE OF HEAVEN	10	4	F	INVASIVE; SOMEWHAT POOR STRUCTURE	IMPACTED; SITE REMEDIATION	M	REMOVE
69	ACER NEGUNDO	MANITоба MAPLE	15	1	F	MODERATE LEAN	IMPACTED; SITE REMEDIATION	M	REMOVE
70	ALANTHUS ALTISSIMA	TREE OF HEAVEN	10-20	13	F	INVASIVE;	IMPACTED; SITE REMEDIATION	M	REMOVE
71	ULMUS PUMILA	SIBERIAN ELM	13	1	F		IMPACTED; SITE REMEDIATION	M	REMOVE
72	ULMUS PUMILA	SIBERIAN ELM	10-40	9	P	EMBEDDED IN FENCE; POOR STRUCTURE	IMPACTED; SITE REMEDIATION	M	REMOVE
73	ACER NEGUNDO	MANITоба MAPLE	20	1	P	EMBEDDED IN FENCE; POOR STRUCTURE	IMPACTED; SITE REMEDIATION	M	REMOVE
74	ALANTHUS ALTISSIMA	TREE OF HEAVEN	10-30	8	F	INVASIVE;	IMPACTED; SITE REMEDIATION	M	REMOVE
75	ACER NEGUNDO	MANITоба MAPLE	25	1	F	MODERATE LEAN	IMPACTED; SITE REMEDIATION	M	REMOVE
76	ACER NEGUNDO	MANITоба MAPLE	50	1	P	CODOMINANT LEADERS (4); EMBEDDED IN FENCE	IMPACTED; SITE REMEDIATION	M	REMOVE
77	ACER NEGUNDO	MANITоба MAPLE	40	2	P	CODOMINANT LEADERS (6-1); EMBEDDED IN FENCE	IMPACTED; SITE REMEDIATION	M	REMOVE
78	ALANTHUS ALTISSIMA	TREE OF HEAVEN	12-17	2	F	INVASIVE; CODOMINANT LEADERS (3); TRUNK DAMAGE	IMPACTED; SITE REMEDIATION	M	REMOVE
79	ALANTHUS ALTISSIMA	TREE OF HEAVEN	10-40	8	P	INVASIVE; TRUNK DAMAGE	IMPACTED; SITE REMEDIATION	M	REMOVE
80	ACER NEGUNDO	MANITоба MAPLE	70	1	P	SEVERE LEAN	IMPACTED; SITE REMEDIATION	M	REMOVE
81	ALANTHUS ALTISSIMA	TREE OF HEAVEN	15	1	D	INVASIVE;	IMPACTED; SITE REMEDIATION	M	REMOVE
82	ULMUS PUMILA	SIBERIAN ELM	10-30	5	P	POOR STRUCTURE	IMPACTED; SITE REMEDIATION	M	REMOVE
83	ALANTHUS ALTISSIMA	TREE OF HEAVEN	12-60	8	P	INVASIVE;	IMPACTED; SITE REMEDIATION	M	REMOVE
84	(STUMPS)		10-30	21	D		IMPACTED; SITE REMEDIATION	M	REMOVE
85	ULMUS PUMILA	SIBERIAN ELM	20-90	14	P	LEANING; TRUNK AND BRANCH DAMAGE; CODOMINANT LEADERS	IMPACTED; SITE REMEDIATION	M	REMOVE
86	ACER NEGUNDO	MANITоба MAPLE	22	1	P	CODOMINANT LEADERS (7); EMBEDDED IN FENCE	IMPACTED; SITE REMEDIATION	M	REMOVE
87	ALANTHUS ALTISSIMA	TREE OF HEAVEN	15	2	P	INVASIVE; POOR STRUCTURE	IMPACTED; SITE REMEDIATION	M	REMOVE
88	ULMUS PUMILA	SIBERIAN ELM	15-17	2	P	EMBEDDED IN FENCE	IMPACTED; SITE REMEDIATION	M	REMOVE
89	ULMUS PUMILA	SIBERIAN ELM	15	2	P	EMBEDDED IN FENCE; POOR STRUCTURE	IMPACTED; SITE REMEDIATION	M	REMOVE
90	ULMUS PUMILA	SIBERIAN ELM	10-20	3	P	POOR STRUCTURE	IMPACTED; SITE REMEDIATION	M	REMOVE
91	ULMUS PUMILA	SIBERIAN ELM	40	1	P	FUSING WITH ADJACENT TREE	IMPACTED; SITE REMEDIATION	M	REMOVE
92	ALANTHUS ALTISSIMA	TREE OF HEAVEN	15-40	2	P	INVASIVE; EMBEDDED IN FENCE	IMPACTED; SITE REMEDIATION	M	REMOVE
93	TILIA AMERICANA	BASSWOOD	20-30	3	F		IMPACTED; SITE REMEDIATION	M	REMOVE
94	ULMUS PUMILA	SIBERIAN ELM	10	7	P		IMPACTED; SITE REMEDIATION	M	REMOVE
95	ULMUS PUMILA	SIBERIAN ELM	10-12	4	P		IMPACTED; SITE REMEDIATION	M	REMOVE
96	ACER NEGUNDO	MANITоба MAPLE	15-35	5	F		NONE	M	PRESERVE

ID	BOTANICAL NAME	COMMON NAME	DBH (RANGE)	# OF UNITS	CONDITION(1)	COMMENTS(2)	IMPACTS OF DEVELOPMENT (3)	OWNERSHIP(4)	RECOMMENDATION (5)
96	ACER NEGUNDO	MANITоба MAPLE	30	1	F		NONE	M	PRESERVE
97	ULMUS PUMILA	SIBERIAN ELM	30	3	F		NONE	M	PRESERVE
98	ALANTHUS ALTISSIMA	TREE OF HEAVEN	15-30	3	F	ADJACENT PROPERTY	NONE	M	PRESERVE
99	ALANTHUS ALTISSIMA	TREE OF HEAVEN	18	1	F	INVASIVE; EMBEDDED OR LEANING ON FENCE	NONE	M	PRESERVE
100	ALANTHUS ALTISSIMA	TREE OF HEAVEN	10	1	P	INVASIVE;	NONE	M	PRESERVE
101	ALANTHUS ALTISSIMA	TREE OF HEAVEN	20-35	2	F	INVASIVE; TRUCK BOX STORED ON ROOTS (ADJACENT PROPERTY)	NONE	M	PRESERVE
102	CARYA CORDIFORMIS	BITTERNUT HICKORY	26-30	5	G		NONE	M	PRESERVE
103	FINUS STROBUS	EASTERN WHITE PINE	25-27	1	F	POOR STRUCTURE ON UNITS CLOSEST TO BUILDING	NONE	M	PRESERVE
104	FINUS NIGRA	AUSTRIAN PINE	20-80	10	G		NONE	M	PRESERVE
105	SORBUS X THURINGIACA	OAKLEAF MOUNTAINASH	20-30	3	F		NONE	M	PRESERVE
106	QUERCUS MACROCARPA	BUR OAK	12-22	5	G		NONE	M	PRESERVE
107	QUERCUS MACROCARPA	BUR OAK	16-20	5	G		NONE	M	PRESERVE
108	FINUS NIGRA	AUSTRIAN PINE	19-30	9	F	15-30% NEEDLE BROWNING	NONE	M	PRESERVE
109	SORBUS X THURINGIACA	OAKLEAF MOUNTAINASH	25-30	4	F		NONE	M	PRESERVE
110	QUERCUS RUBRA	RED OAK	22-25	2	F		NONE	M	PRESERVE
111	PICEA GLAUCO	WHITE SPRUCE	10	1	G		NONE	M	PRESERVE
112	PRUNUS SARGENTII	SARGENT CHERRY	20	1	F	CODOMINANT LEADERS (8); STAKE STILL ATTACHED TO CENTRAL LEADER	NONE	M	PRESERVE
113	ALANTHUS ALTISSIMA	TREE OF HEAVEN	30	2	F	INVASIVE; EXPOSED ROOTS	NONE	M	PRESERVE

(1) Condition: Good (G) - dead branches less than 10%; signs of good compartmentalization on any wounds; no structural defects
 Fair (F) - 10-30% dead branches; size or occurrence of wounds present some concerns; minor structural defects
 Poor (P) - more than 30% dead branches; weak compartmentalization; early leaf drop; presence of insects or disease; major structural defects
 Dead (D) - tree shows no signs of life
 Comments based on tree health, condition, structure and existing physical constraints
 (3) Impacts: None - no construction activity occurs at or within the dripline of a tree.
 Limited Impact: XXX - demolition/construction activity occurs at or within the dripline of a tree, but is not likely to lead to tree death in the short term (5-10 years) if precautionary measures are taken; this may require root pruning.
 Impacted: XXX - demolition/construction activity which requires the direct removal of a tree or occurs within a significant portion of the canopy/foot zone, such that the activity will significantly affect tree health leading to death in the short term
 (4) Ownership: Municipal/City-Owned (M) or Private/Non City-Owned (P)
 (5) Recommendation: Preserve, Remove, Transport
 (6) Trees recommended for PRESERVING IN SHADED BOXES

NOTE: PROPERTY LINE INFORMATION IS UNAVAILABLE. FENCELINES ARE ASSUMED TO DELINEATE PROPERTY BOUNDARIES. WHERE FENCELINES DO NOT EXIST, BOUNDARIES HAVE BEEN ASSUMED

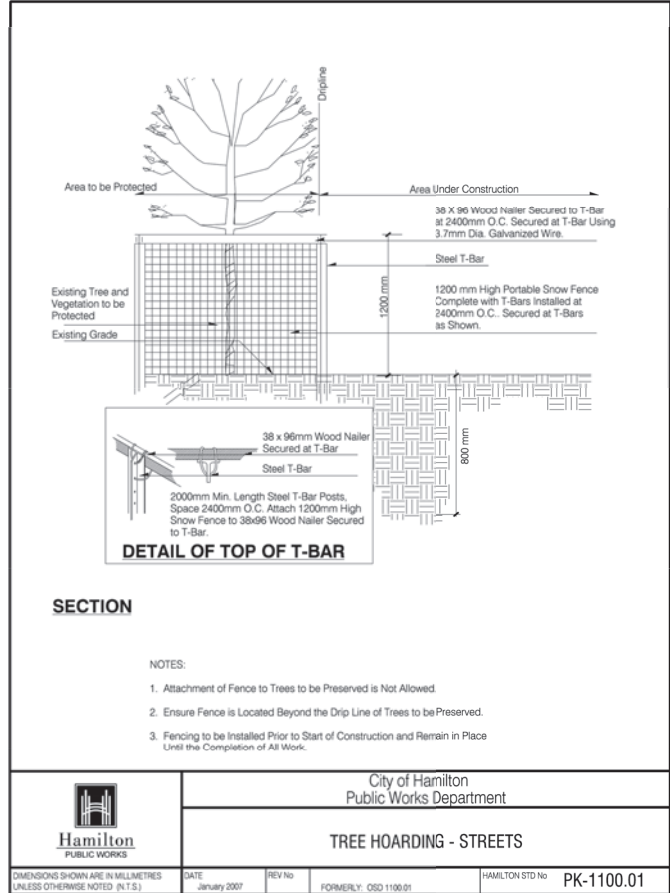

- NOTES:
- Attachment of Fence to Trees to be Preserved is Not Allowed
 - Ensure Fence is Located Beyond the Drip Line of Trees to be Preserved
 - Fencing to be Installed Prior to Start of Construction and Remain in Place Until the Completion of All Work.

City of Hamilton
Public Works Department

TREE HOARDING - STREETS

HAMILTON STD NO: PK-1100.01

1 TREE HOARDING
D-1 N.T.S

NOT FOR CONSTRUCTION

DESIGNED BY: Z.B. CHECKED BY: J.M.
 DRAWN BY: Z.B. DATE: 03/2018

#	DATE	BY	DESCRIPTION
1	2018-03-23	ZB	SUBMITTED FOR CITY OF HAMILTON REVIEW
2	2018-05-08	ZB	RE-SUBMITTED FOR CITY OF HAMILTON REVIEW

REVISIONS



APPROVALS

IBI GROUP
 200 East Wing-360 James Street North
 Hamilton ON L8L 1H5 Canada
 tel 905 546 1010 fax 905 546 1011
 ibigroup.com

CITY OF HAMILTON
ONTARIO, CANADA

HAMILTON TRANSIT FACILITY
80 BRANT STREET, 2 HILLYARD ST &
330 WENTWORTH ST N
HAMILTON, ONTARIO

TREE IDENTIFICATION TABLE

FILE NUMBER: 115096_TPP SHEET NUMBER: L-4