

S.D. McLAREN, O.L.S. - 2002

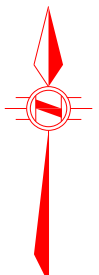

BENCH MARK NOTE:

ELEVATIONS SHOWN ON THIS PLAN ARE GEODETIC AND ARE REFERRED TO CITY OF HAMILTON BENCH MARK No 1-19
 CANADIAN MARTYRS SEPARATE SCHOOL, ON SOUTH SIDE OF MAIN STREET, 75 m WEST OF EMERSON STREET, TABLE IN EAST CONCRETE FOUNDATION WALL, 3.8 m FROM SOUTHWEST CORNER, 0.15 m BELOW STONE SIDING, 5.2 m SOUTH OF SIDE ENTRANCE, AT ROAD LEVEL. No 65-U-033
 ELEVATION - 100.273

LEGEND:

- DENOTES MONUMENT SET
- IRON BAR
- STANDARD IRON BAR
- MB MEASURED
- MB4 A. T. McLAREN, O.L.S.
- MH MANHOLE
- CB CATCH BASIN
- T/L TOP OF LID
- INVERT
- P DIAMETER
- LP LIGHT POLE
- WV WATER VALVE
- VC VALVE CHAMBER
- FH FIRE HYDRANT

NOTE

THE BOUNDARY LOCATION AND DIMENSIONS WERE DERIVED FROM A DRAWING PROVIDED BY McMASTER UNIVERSITY (PROJECT No 95-111 DRAWING No C-01) AND NOT BY AN ACTUAL FIELD SURVEY.

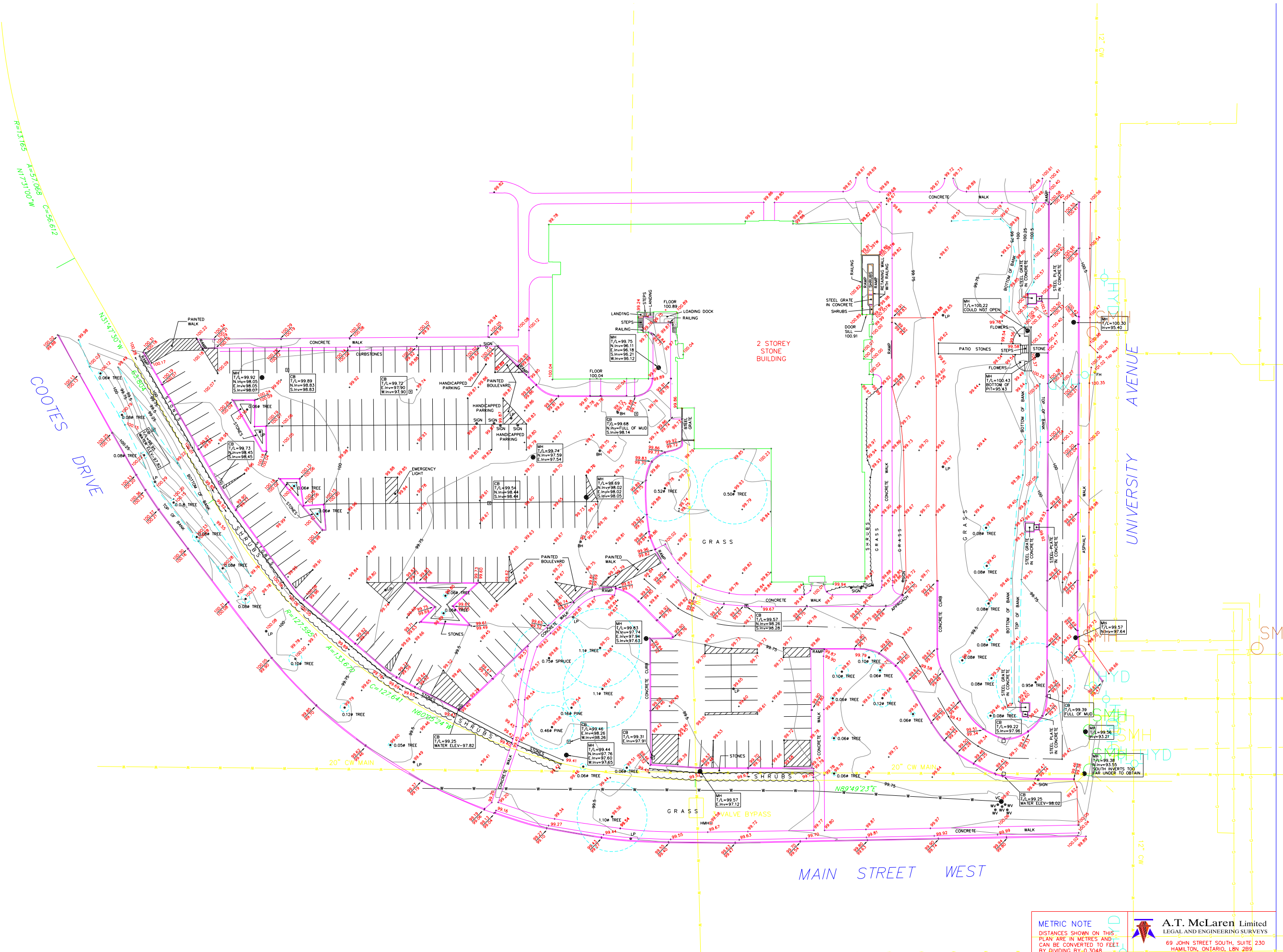

METRIC NOTE
 DISTANCES SHOWN ON THIS PLAN ARE IN METRES AND CAN BE CONVERTED TO FEET BY DIVIDING BY 0.3048

A.T. McLaren Limited
 LEGAL AND ENGINEERING SURVEYS
 69 JOHN STREET SOUTH, SUITE 230
 HAMILTON, ONTARIO, L8N 2B9
 PHONE (905) 527-8559 FAX (905) 527-0032

Drawn RBM Checked MW Scale 1:400 Dwg.No. 30178

DECEMBER 11, 2002
 DATE